



DOLLAR TREE | NN LEASE EXTENSION

860 S CHEROKEE DR., MARSHALL, MO 65340

REPRESENTATIVE STORE

30445 Northwestern Highway, Suite 275
Farmington Hills, MI 48334
248.254.3410
fortisnetlease.com

ANDY BENDER

INVESTMENT ADVISOR
D: 248.419.3657

ABENDER@FORTISNETLEASE.COM

COREY BUNCH

INVESTMENT ADVISOR
D: 248.419.3627

CBUNCH@FORTISNETLEASE.COM

BRYAN BENDER

MANAGING DIRECTOR
D: 248.419.3810

BBENDER@FORTISNETLEASE.COM

DISCLOSURE :

All materials and information received or derived from Fortis Net Lease (hereinafter collectively referred to as “FNL”), its directors, officers, agents, advisors, affiliates and/or any third party sources are provided without representation or warranty by FNL its directors, officers, agents, advisors, or affiliates as to completeness, veracity, or accuracy, condition of the property, compliance or lack of compliance with applicable governmental requirements, suitability, financial performance of the property, projected financial performance of the property for any party’s intended use or any and all other matters.

Neither FNL its directors, officers, agents, advisors, or affiliates makes any representation or warranty, express or implied, as to accuracy or completeness of the any materials or information provided, derived, or received. Materials and information from any source, whether written or verbal, that may be furnished for review are not a substitute for a party’s active conduct of its own due diligence to determine these and other matters of significance to such party. FNL will not investigate or verify any such matters or conduct due diligence for a party unless otherwise agreed in writing.

ALL PARTIES SHALL CONDUCT THEIR OWN INDEPENDENT INVESTIGATION AND DUE DILIGENCE:

Any party contemplating or under contract or in escrow for a transaction is urged to verify all information and to conduct their own inspections and investigations including through appropriate third party independent professionals selected by such party.

All financial data should be verified by the party including by obtaining and reading applicable documents and reports and consulting appropriate independent professionals. FNL makes no warranties and/or representations regarding the veracity, completeness, or relevance of any financial data or assumptions. FNL does not serve as a financial advisor to any party regarding any proposed transaction. All data and assumptions regarding financial performance, including that used for financial modeling purposes, may differ from actual data or performance. Any estimates of market rents and/or projected rents that may be provided to a party do not necessarily mean that rents can be established at or increased to that level. Parties must evaluate any applicable contractual and governmental limitations as well as market conditions, vacancy factors and other issues in order to determine rents from or for the property.

Legal questions should be discussed by the party with an attorney. Tax questions should be discussed by the party with a certified public accountant or tax attorney. Title questions should be discussed by the party with a title officer or attorney. Questions regarding the condition of the property and whether the property complies with applicable governmental requirements should be discussed by the party with appropriate engineers, architects, contractors, other consultants and governmental agencies. All properties and services are marketed by FNL in compliance with all applicable fair housing and equal opportunity laws.

EXCLUSIVELY LISTED BY:

ANDY BENDER

INVESTMENT ADVISOR

D: 248.419.3657

ABENDER@FORTISNETLEASE.COM

COREY BUNCH

INVESTMENT ADVISOR

D: 248.419.3627

CBUNCH@FORTISNETLEASE.COM

BRYAN BENDER

MANAGING DIRECTOR

D: 248.419.3810

BBENDER@FORTISNETLEASE.COM

Missouri Broker of Record:

Adam Blue | Area Real Estate Advisors

MO License #2002027677

INVESTMENT SUMMARY

List Price:	\$925,490
List Price NOI:	\$70,800 (Includes Capital Reserves)
Initial Cap Rate:	7.65%
Land Acreage:	+/-0.82 Acres
Year Built	2009
Building Size:	8,000 SF
Price PSF:	\$115
Lease Type:	NN+
Term Remaining:	5.6 Years

INVESTMENT OFFERING

Fortis Net Lease is pleased to present this 8,000 SF Dollar Tree store located in Marshall, MO. The property is encumbered with a NN Lease, leaving Limited landlord responsibilities. The lease contains 2 (5) Yr. Options to renew, each with a rental rate increase. The lease is corporately guaranteed by Dollar Tree Corporation which holds a credit rating of “BBB-”. Dollar Tree recently extended the lease term through 8/31/2024, showing the continued success, and corporate belief in this location.

This Dollar Tree is highly visible as it is strategically positioned on Cherokee Dr. off Lexington Ave. The five-mile population from the site is 14,305 while the one-mile average household income \$51,927 per year, making this location ideal for a Dollar Tree. The Subject offering represents an ideal opportunity for a 1031 exchange buyer or a “passive” investor to attain the fee simple ownership of a Dollar Tree. List price reflects a 7.65% cap rate based on NOI of \$70,800.



PRICE \$925,490



CAP RATE 7.65%



LEASE TYPE NN+



TERM REMAINING 5.6 Years

INVESTMENT HIGHLIGHTS

- NN Lease | Limited Landlord Responsibilities
- 5.6 Year Remaining / 2 (5 Year) Options
- One Mile Household Income \$51,927
- Five Mile Population 14,305
- Walmart Out Parcel | Major Retail Area
- Traffic Count - 11,492 cars per day

FINANCIAL SUMMARY

INCOME		PER SF
Dollar Tree Rent	\$72,000	\$9.00
Gross Income	\$72,000	\$9.00
EXPENSE		PER SF
Expenses (Reserves at \$.15 PSF)	\$1,200	\$0.15
Gross Expenses	\$1,200	\$0.15
NET OPERATING INCOME	\$70,800	\$8.85

PROPERTY SUMMARY

Year Built:	2009
Lot Size:	0.82 Acres
Building Size:	8,000 SF
Traffic Count:	11,492
Roof Type:	Standing Seam
Zoning:	Commercial
Construction Style:	Prototype
Parking Lot:	Asphalt
HVAC	Roof Mounted

LEASE SUMMARY

Tenant:	Dollar Tree
Lease Type:	NN+
Term Remaining:	5.6+ Years
Annual Rent:	\$72,000
Rent PSF:	\$9.00
Landlord Responsibilities:	Roof and Structure
Taxes, Insurance & CAM:	Tenant
Roof, Structure & Parking:	Landlord
Lease Start Date:	9/1/2019 (This Term)
Lease Expiration Date:	8/31/2024
Rent Bumps:	In Options
Renewal Options:	2 (5 Years)
Lease Guarantor:	Dollar Tree Stores, Inc.
Lease Guarantor Strength:	BBB-
Tenant Website:	www.DollarTree.com



GROSS SALES:
\$22.25 BILLION



STORE COUNT:
15,000 +



GUARANTOR:
DOLLAR TREE



S&P:
BBB-

TENANT NAME	UNIT NUMBER	UNIT SIZE (SF)	LEASE START	LEASE END	ANNUAL RENT	% OF GLA	ESC DATE	RENT PER SF/YR
Dollar Tree		8,000	9/1/2009	8/31/2024	\$72,000	100.0		\$9.00
							9/1/2024	\$10.00
							9/1/2029	\$10.50
Totals/Averages		8,000			\$72,000			\$9.00

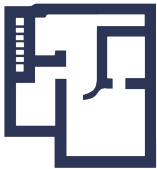

TOTAL SF
8,000



TOTAL ANNUAL RENT
\$72,000



OCCUPANCY RATE
-



AVERAGE RENT/SF
\$9.00



NUMBER OF TENANTS
-



OVERVIEW

Company:	Dollar Tree
Founded:	1986
Total Revenue:	\$22.25 Billion
Net Income:	\$1.714 Billion
Headquarters:	Chesapeake, Virginia
Website:	www.DollarTree.com

TENANT HIGHLIGHTS

- \$20+ Billion Market Capital in 2018
- Same Store Sales Increases 3.7% in 2017
- Ranked #136 on Fortune 500
- Recently Opened it's 15,000th store in the USA
- Boasts a staggering revenue exceeding \$5.5 billion

RENT SCHEDULE

LEASE YEARS	ANNUAL RENT	MONTHLY RENT	BUMP	YIELD
Current - 8/31/2024	\$72,000	\$6,000	-	7.65%
Option 1	\$80,000	\$6,666	11%	8.50%
Option 2	\$84,000	\$7,000	5%	8.93%

DOLLAR TREE

Dollar Tree, Inc. operates discount retail stores in the United States and Canada. The company operates in two segments, Dollar Tree and Family Dollar. The Dollar Tree segment offers merchandise at the fixed price of \$1.00. It provides consumable merchandise, including candy and food, and health and beauty care products, as well as everyday consumables, such as household paper and chemicals, and frozen and refrigerated food; various merchandise.

This segment operates under the Dollar Tree, Dollar Tree Canada, Deals, and Dollar Tree Deals brands, as well as 10 distribution centers in the United States and 2 in Canada, and a store support center in Chesapeake, Virginia. A Fortune 500 Company, Dollar Tree is headquartered in Chesapeake, Virginia and was founded in 1953. The name of the company Only \$1.00 was changed to Dollar Tree Stores in 1993 and, shortly thereafter, in 1995, the company went public with a market value of \$225 million. Today, Dollar Tree is a \$20+ billion dollar company and a premier operator in its industry.

DOLLAR TREE

860 S CHEROKEE DR., MARSHALL, MO 65340



 FORTIS NET LEASE™





DOLLAR TREE

860 S CHEROKEE DR., MARSHALL, MO 65340

 FORTIS NET LEASE™



DOLLAR TREE

860 S CHEROKEE DR., MARSHALL, MO 65340 

 **FORTIS NET LEASE**™

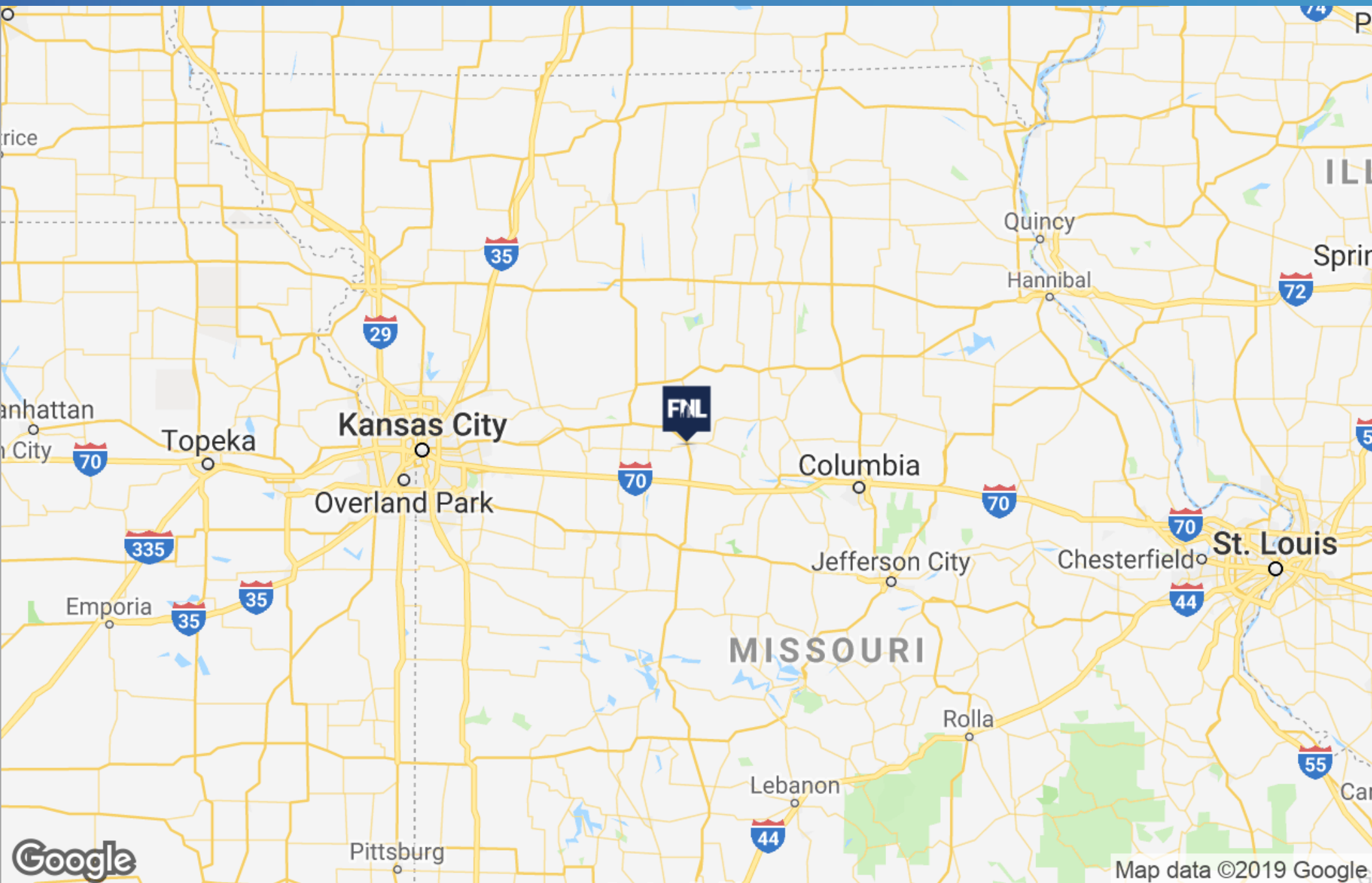



Marshall is a city in Saline County, Missouri which happens to be less than an hour away from Columbia, MO. Columbia is known as an ideal college town, combining small-town comforts, community spirit and low cost of living with big-city culture, activities and resources. There are many Famous Celebrities born and raised in Columbia, Missouri. Some of the Celebrities are: Jessica Capshaw, Carlos Pena Jr., Michael Porter Jr., Oliver Francis, Robert Patrick Benedict and Carl Edwards.

Columbia is home to nationally renowned public schools, including two top-ranked high schools. It also supports other institutes of higher education, including Columbia College, which is ranked among "America's Best Colleges" by U.S. News & World Report, and Stephens College, a women's college known for its fashion, film and fine arts. The American Institute for Economic Research ranked Columbia among the nation's top 10 college towns.

POPULATION	1 MILE	3 MILES	5 MILES
Total Population 2018	5,166	13,377	14,305
Average Age	37.9	37.00	37.40
# Of Persons Per HH	2.00	2.00	2.00
HOUSEHOLDS & INCOME	1 MILE	3 MILES	5 MILES
Total Households	2,108	4,954	5,287
Average HH Income	\$51,927	\$53,341	\$54,476
Consumer Spending (Thousands)	\$43,409	\$104,624	\$113,545





TOTAL SALES VOLUME

\$5.5B

PROPERTIES SOLD

2,500+

BROKER & BUYER REACH

345K

STATES SOLD IN

40

The FNL Team

30445 Northwestern Highway, Suite 275

Farmington Hills, MI 48334

248.254.3410

fortisnetlease.com

ANDY BENDER

INVESTMENT ADVISOR

D: 248.419.3657

ABENDER@FORTISNETLEASE.COM

COREY BUNCH

INVESTMENT ADVISOR

D: 248.419.3627

CBUNCH@FORTISNETLEASE.COM

EXCLUSIVELY LISTED BY:

BRYAN BENDER

MANAGING DIRECTOR

D: 248.419.3810

BBENDER@FORTISNETLEASE.COM